

*Adopted 2014*

## **TABLE OF CONTENTS**

- 1- RESPONSIBILITIES OF COMMITTEE**
- 2- GENERAL LANDSCAPE CRITERIA FOR FIELDSTONE**
- 3- DESIGN**
- 4- PLANT LIST**
- 5- CONTRACT**
- 6- YEARLY BUDGET**
- 7- CC&R'S APPLIED TO LANDSCAPE**

## **RESPONSIBILITIES OF LANDSCAPE COMMITTEE**

- 1- INTERVIEW POTENTIAL LANDSCAPE CONTRACTORS AND MAKE RECOMMENDATIONS TO THE BOARD.**
- 2- REVIEW CONTRACT YEARLY.**
- 3- REVIEW LANDSCAPE WORK ON A REGULAR BASIS AND MAKE SURE THE CONTRACT IS BEING FULFILLED.**
- 4- MAINTAIN CURRENT LANDSCAPE DESIGN SELECTING APPROPRIATE PLANTS FOR FILL IN AND PLANT REPLACEMENT.**
- 5- CONSULT WITH BOARD AS NEEDED ON HOMEOWNER LANDSCAPE ISSUES.**
- 6- HAVE COMMITTEE MEETINGS AS NEEDED.**
- 7- GIVE LANDSCAPE REPORT AT EACH BOARD MEETING.**
- 8- REPORT ANY LANDSCAPE VIOLATIONS TO BOARD OF DIRECTORS.**

## General Landscape Criteria for Fieldstone

### Plant Selection:

Plants must be suited to area—Zone #<sup>7</sup>~~3~~ (Sunset Western Garden Guide)

Must be heat tolerant and frost tolerant with low water usage

Must be suited to poor soil with low maintenance requirement

Must be insect resistant and non fruit-bearing

Must be readily available

### Aesthetics:

Balance of deciduous and evergreens

Different color of foliage and shape of leaves

Some flowering and some berries

Seasonal color

### Design:

Treat as one entity—not 46—Continuity being priority

Use groupings of same plants repeated throughout area - FLOW

Trees and shrubs sized right for location

Ground-cover or low- spreading plant rather than bark or gravel to cover dirt

Only plants from approved list which has been developed from experience, professional advice and some trial and error

# Design

Use groupings of same plant—not a lot of different ones.

Repeat similar patterns in yards with some continuity between houses and across street. AGAIN, treating as one single unit not 46 individuals ones.

The number of different varieties used per house should be appropriate for size of yard. Smaller spaces might have two while larger areas have five.

Establish universal pruning standards. It is not practical to have house by house variations.

Keep shrubs below porch rail, below midpoint of windows and no more than 6 feet in height.

Use taller plants in back and smaller ones to front.

Use natives from area when appropriate.

Avoid perennials which require a lot of maintenance and no annuals.

Only plants from approved list should be used.

# Fieldstone Plant List

August 16, 2013

common name	scientific name	location	size	notes	E/P/D
<b>Shrubs</b>					
candytuff	iberis		253 ground	white flowers	P
cotoneaster			167 ground		E
Cotoneaster			225 shrub		E
red hot poker	kniphofia	pool area	med	red	P
Dwarf Fire Power Bamboo	nandina	mailbox	sm	fall color	
Dwarf Gulf Stream Bamboo	nandina	entrance	sm	fall color	E
Heavenly Bamboo	nandina domestica		233 med	against fence	E
Barberry, Crimson Pigmy	berberis, atropurpurea		327 sm	wine	D
Barberry, Crimson	berberis		141 med	Crimson	D
barberry, green			167 med		E
barberry, Rose Glow	berberis, atropurpurea		med		D
Russian Sage	Perovskia atriplicifolia		167 med		P
Butterfly Bush	Buddlea		106 tall		D
Photinia			141 tall		E
Wild Lilac, carmel creeper	ceanothus		260 ground		E
Indian Hawthorne	Rhaphiolepis, Clara		123 low growing	white flowers	E
Indian Hawthorne	Rhaphiolepis, Ballertna		123	deep pink	E
Rosemary officinales			ground		E
Rosemary prostratus			220 ground		E
Flowering Quince	chaenomeles		233 med		D
germander	teucrium fruticans	mailbox	Upright Med Shrub		E
germander	teucrium chamaedrys	mailbox	ground cover	grey leaves, blue flowers	E
welgela	weigela		186 med shrub	red flowers	D
spirea			159 med shrub	pink flowers	
spirea	spirea	entrance	med shrub	lime green	D
viburnum, deciduous	same		269 small		D
viburnum, spring bouquet	same		355 med shrub		E
euonymus, emerald & gold	same		171 small		E

Evergreen  
Deciduous  
Perennial  
E

# Fieldstone Plant List

August 16, 2013

euonymus, silver queen	same	225 med/lg shrub		E
Oregon grape	mahonia	159 lg shrub	purple berries	E
Lavender, spanish	lavandula stoechas	281 med shrub		P
Lavender, french	lavandula Intermedia	362 med		P
Boxwood, Japanese	buxus	142 med shrub		E
Holly	illex	355 med shrub	red berries	E
day lily	hemerocallis	265 small		P
catmint	nepeta	221 ground cover	evergreen	P
abella, sunrise		med		D
abella, kaleidoscope				
abella, Edward Goucher		med		D
yarrow	achillea	med	ISLAND	P
lily of the Nile	agapantha	med	POOL	P
manzanita	arctostaphlos, Howard McMinn	med shrub	186	E
emerald carpet	arctostaphlos	ground	339	E
wallflower	erysimum, bowles mauve	med	205 mauve	P
<del>santa barbara daisy</del>	<del>erigeron</del>	ground		P
<b>TREES</b>				E
Crepe myrtle	lagerstroemia Indica	120 tree		D
chinese pistache	pisticia chinensis	225 tree	30-60 ft	D
coastal redwood	sequola sempervirens	186 tree		E
strawberry tree	arbutus	205 tree		D
cercis, eastern	cercis	ISLAND tree		D
cercis, western	cercis	123 tree		D
raywood	fraxinus-angustifolia	141 tree		D
Alberta Spruce, dwarf	picea conica	Entrance tree		E
<b>Grasses</b>				
liriope	same	mailbox		
rain grass	zephyranthes candida	142		
blue fescue				

E - Evergreen  
 P - Perineal  
 D - Deciduous

MORE TREES

LINDEN

289

Crabapple

269

Hawthorne

174

Red Oak

159

Red Maple

327

October Glory Maple

123

# Plot Map

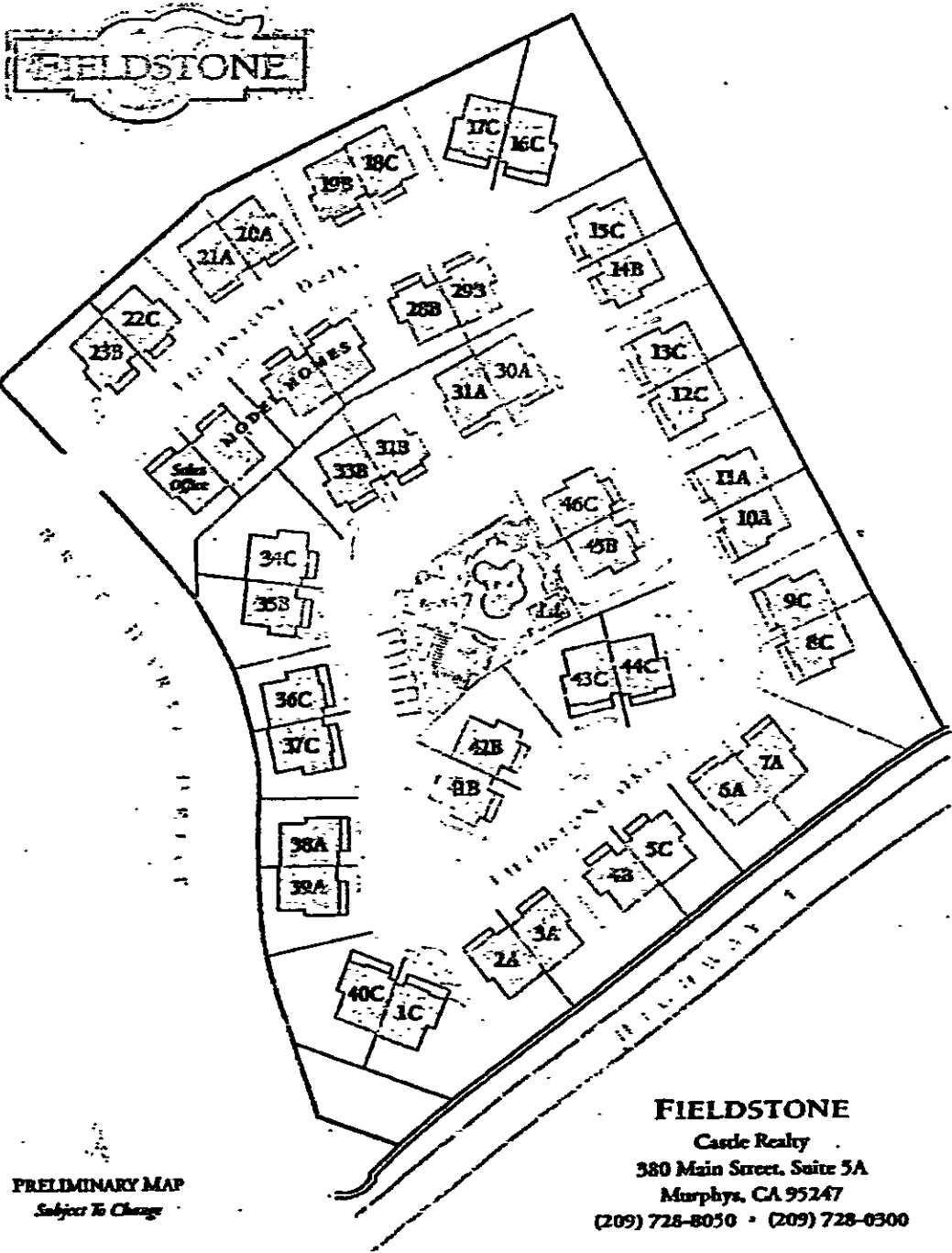

PRELIMINARY MAP  
Subject To Change

**FIELDSTONE**  
Castle Realty  
380 Main Street, Suite 5A  
Murphys, CA 95247  
(209) 728-8050 • (209) 728-0300